

**ORIGINAL**

**CLASSIC**

**Dimensions & Weights**

**WEIGHTS**.....Kg

Rigidtop/Stiftop..... 1.48

Top ..... 1.15

Shelf ..... 1.09

Bottom ..... 0.96

Body Panel.....4.63

Pole Set (six pieces) **H** .....2.40

Header.....0.72

Pole Set (six pieces) **M** Roof Kit .....2.36

Roof Kit ..... 1.78

Door Panel.....0.85

Bag..... 1.40

**PACKING**

Individual Reusable Carton ..... 1.00

External Measurements  
920mm x 560mm x 150mm

Bulk packaging, dimensions and weight dependent on number of units required.

*Weights and measurements quoted are approximate.*

**ABC** Your exhibition partner for portable and folding displays and stands. Lay-outs, graphics and digital printing.  
**E X P O**  
[www.abc-expo.be](http://www.abc-expo.be)

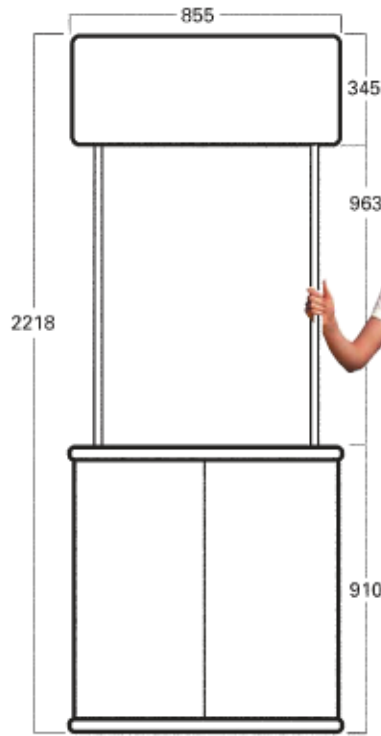

**UNIT AND HEADER**

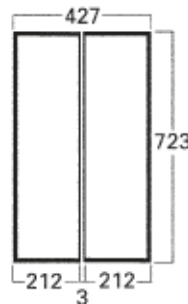

**ROOF PANELS**

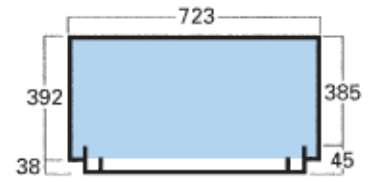

**ROOF KIT HEADER**  
**VISUAL GRAPHIC SIZE**

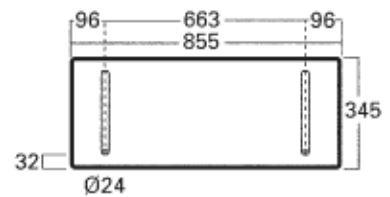

**HEADER**

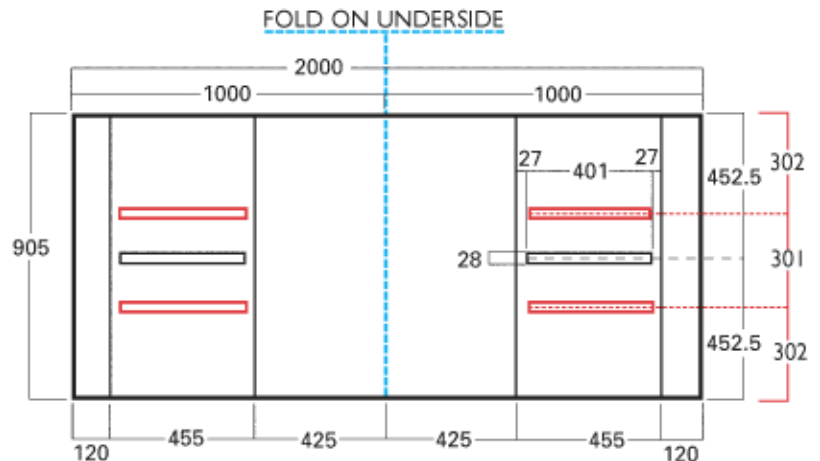

**GRAPHIC SIZE FOR ONE AND TWO SHELF UNIT**

ALLOW 37.5mm FOR TOP AND BOTTOM